

BRASSMASTER PLUS+

Water Softening & Filtration Systems

RESIDENTIAL

MultiMAX

MultiMAX^{LS}

CARBON MEDIA CHANGEOUT INSTRUCTIONS FOR ALL MultiMAX and MultiMAX-LS SYSTEMS



Required time: 45 minutes | To be included with media replacement kits P/N: MTM-100-RB, MTM-100-LS-RB, MTM-200-RB, and MTM-200-LS-RB.

STEP 1:

Open system bypass valve by turning handle 90 degrees. Valve indicator should now align with "Bypass" [and not "Service"].



STEP 2:

Press and hold system regeneration button for 5 seconds, then release. This will put system into "BW" mode [backwash] and relieve water pressure. Once drain line water flow stops, unplug control valve from power supply.



STEP 3:

Remove drain line tubing by compressing black coupling on drain line quick connect fitting, while pulling out drain tube.

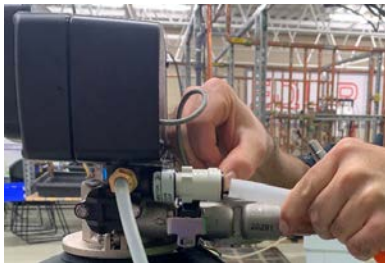

STEP 4:

Remove bypass assembly clips with 5/16" nut driver.

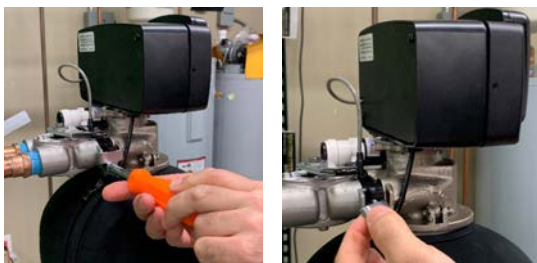

WR-BM-MMX-INSTR © Water Control Corporation 0522

CARBON MEDIA CHANGEOUT INSTRUCTIONS FOR all MultiMAX and MultiMAX-LS systems [continued]

STEP 5:

Pull bypass assembly away from valve.



STEP 6:

Remove 2 APM cotter pins [one on each side of valve].



STEP 7:

Remove 2 APM module pins [one on each side of valve].



STEP 8:

Remove valve from tank by pulling upward. Unzip jacket to allow power cord to move freely. Set valve aside on stable surface.

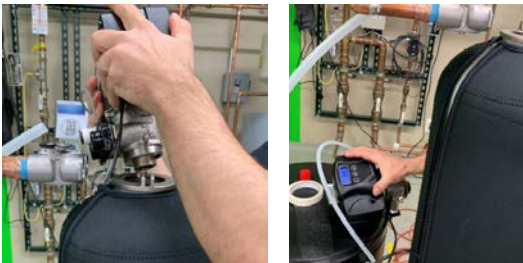

STEP 9:

Place red cap over distributor tube in tank and affix using masking or duct tape.

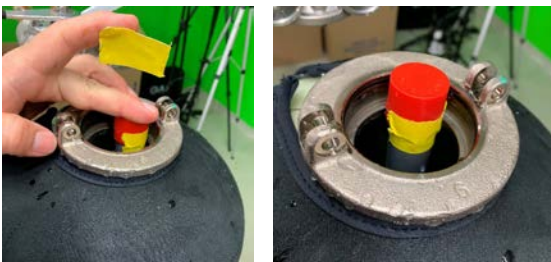

CARBON MEDIA CHANGEOUT INSTRUCTIONS FOR all MultiMAX and MultiMAX-LS systems [continued]

STEP 10:

Prepare Shop Vac hose with extra long crevice tool: or [alternatively] affix a ½" or ¾" PVC pipe to the end of shop vac hose, using duct tape. Ensure that PVC pipe or crevice tool is minimum 27" long for MTM-100 and MTM-200 units or 54" long for MTM-100-LS and MTM-200-LS units.



STEP 11:

Use shop vac to vacuum out expired black-colored carbon media from tank. Note: do not remove any gravel from the bottom of the tank. Optional: To reduce water spillage, use some plastic tubing to siphon excess water out of top of media tank before vacuuming.



STEP 12:

Place plastic funnel [included] into top of tank. Use funnel to pour entire bag of replacement media into tank.



STEP 13:

Remove red cap from distributor tube and re-install control valve onto tank. Be sure to re-install APM module pins and cotter pins.

Note: WCC recommends lubricating all rubber o-rings with standard silicone lubricant prior to re-installing control valve.

Note: If distributor tube has risen up in tank, and valve cannot be properly re-installed as a result, blow compressed air down into plastic distributor tube while pressing down on tube until it re-seats in tank bottom [use duct tape to create a seal around air chuck fitting]. Do not attempt to hammer tube down into tank. Do not cut tube.

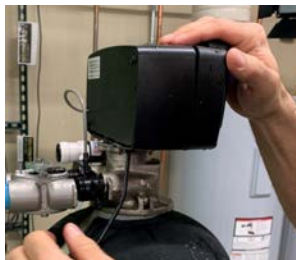
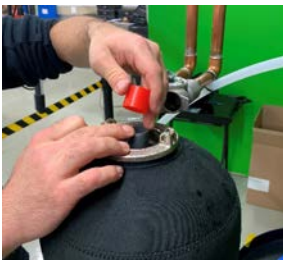

CARBON MEDIA CHANGEOUT INSTRUCTIONS FOR all MultiMAX and MultiMAX-LS systems (continued)

STEP 14:

Re-attach bypass assembly to control valve. Be sure to re-install bypass clips. Re-attach drain line by inserting into Quick Connect fitting.



STEP 15:

Plug control valve back into power supply. Press regeneration button repeatedly until valve control screen displays "RR" [rapid rinse]. Note: You will have to wait 30 seconds for the valve to cycle positions each time you press the button. Once in "RR" mode, slowly open bypass valve and allow water to refill tank. Once it starts flowing out of drain line, allow it to run for 2 additional minutes.



STEP 16:

Press regeneration button repeatedly until valve control screen displays "BW" [backwash]. Note: You will have to wait 30 seconds for the valve to cycle positions each time you press the button. Run unit in backwash mode until carbon media ceases to come out of drain line. Carbon media is easy to see, as it is black in color. When water flowing out of drain line is clear, use regeneration button again to advance unit back into service mode (look for faucet symbol on control screen). Note that you'll have to advance past "BD, RR, and BR".



STEP 17:

Reset time of day on control valve by holding the up or down arrow button. Be sure the AM and PM settings are correct. Once correct time has been entered, press regeneration button to lock in settings.



If you have any questions or concerns, please contact WCC at 1-866-405-1268 or techsupport@watercontrolinc.com.

Thank you for your business.